

Heater Cartridge & Platinum Resistance Thermometer (PRT) Sensor for Agilent 5890 GCs

- Use with 5890 FID and split/splitless weldments.
- Meets or exceeds original manufacturer's performance.

Description	Similar to Agilent Part #	qty.	cat.#
Injector/FID Heater and Injector/FID PRT Sensor	05890-61140	kit	22068
Injector/FID Heater	19231-60620	ea.	22069
Injector/FID PRT Sensor	19231-60660	ea.	23035

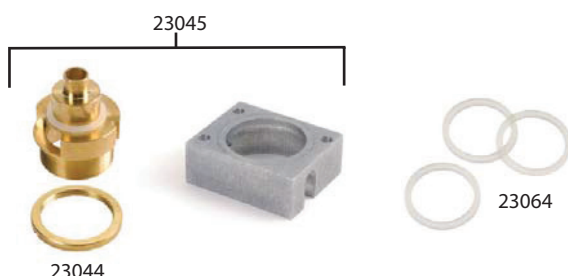

FID Collector Housing Kits for Agilent GCs

- Meets or exceeds original manufacturer's performance.
- Available for Agilent 5890, 6890, or 7890 GCs.

Description	Similar to Agilent Part #	qty.	cat.#
FID Collector Housing Kit for Agilent 5890 GCs (includes collector body, spanner nut, and silicone washer—order mount separately)	19231-20920	kit	23037
FID Collector Housing Kit for Agilent 6890/7890 GCs (includes collector body, silicone washer, nut, and mount)	G1531-20550	kit	23045
FID Collector Housing for Agilent 6890/7890 GCs	G1531-20740	ea.	23044
Replacement Silicone Washers for FID Collector Housing for Agilent 5890/6890/7890 GCs	5180-4165	12-pk.	23064

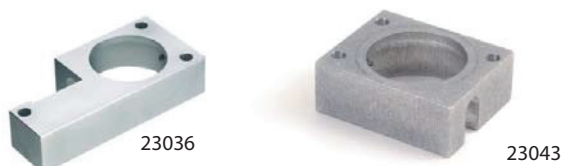

FID Collector Mount for Agilent GCs

- Meets or exceeds original manufacturer's performance.
- Available for Agilent 5890, 6890, or 7890 GCs.

Description	Similar to Agilent Part #	qty.	cat.#
FID Collector Mount for Agilent 5890 GCs	19231-20930	ea.	23036
FID Collector Mount for Agilent 6890/7890 GCs	G1531-20550	ea.	23043



FID Base Weldment for Agilent GCs

- Meets or exceeds original manufacturer's performance.
- Includes brass nut.
- Available for Agilent 5890, 6850, or 6890 GCs.

Description	Similar to Agilent Part #	qty.	cat.#
FID Base Weldment for Agilent 5890 GCs	19231-80580	ea.	23041
FID Base Weldment, Pack Column FID for Agilent 6850/6890 GCs	G1531-80580	ea.	23052
FID Base Weldment, Capillary Column FID for Agilent 6850/6890 GCs	G1531-80630	ea.	23053

Note: 6890 GC connections to EPC modules are not compatible with the 7890 EPC modules.

Spanner Wrench

for Agilent 6890/6850/6890/7890 FID Collector Assemblies

- Easily remove the nut from the FID collector without damaging the nut.
- Unique, ergonomic handle—easy to grip.
- Fits all instrument models.

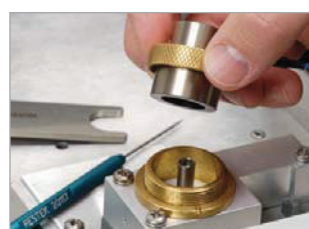

Remove FID ignitor castle.



Easily loosen the nut by aligning the two pins on the bottom of the wrench with the two open slots on the nut...



then turn counterclockwise...



and remove.

Description	Similar to Agilent Part #	qty.	cat.#
Spanner Wrench for Agilent 5890/6890/6850/7890 FID Collector Assembly	19231-00130	ea.	22329



- FID Collector Assembly Kit** for Agilent 5890 GCs
- Constructed of high-quality stainless steel.
 - Meets or exceeds original manufacturer's performance.
 - Individual replacement parts available.

Description	Similar to Agilent Part #	qty.	cat.#
FID Collector Assembly Kit (includes insulators)	19231-60690	kit	23010
FID Collector Assembly Kit w/Siltek Ignitor Castle		kit	21131
FID Collector (includes insulators)	19231-20970, 19231-20960, 19231-20950	ea.	21138
FID Collector Nut and Washer	19231-20940, 5181-3311	set	21136
FID Ignitor*	19231-60680	ea.	21001
FID Ignitor Castle	19231-20910	ea.	21137
Siltek FID Ignitor Castle		ea.	21135

*Also fits OI Analytical 4410 detector (similar to OI part # 191833).

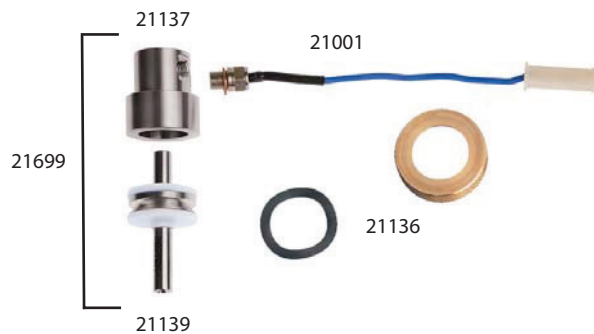

- FID Collector Assembly Kit** for Agilent 6850/6890/7890 GCs
- Constructed of high-quality stainless steel.
 - Meets or exceeds original manufacturer's performance.
 - Individual replacement parts available.

Description	Similar to Agilent Part #	qty.	cat.#
FID Collector Assembly Kit (includes insulator)	G1531-60690	kit	21699
FID Collector Assembly Kit w/Siltek Ignitor Castle		kit	21132
FID Collector (includes insulators)	G1531-20690, G1531-20700	ea.	21139
FID Collector Nut and Washer	19231-20940, 5181-3311	set	21136
FID Ignitor*	19231-60680	ea.	21001
FID Ignitor Castle	19231-20910	ea.	21137

*Also fits OI Analytical 4410 detector (similar to OI part # 191833).



- FID Flow Measuring Adaptor** for Agilent 5890/6890/6850/7890 GCs
- Makes setting flows easy.
 - Meets or exceeds original manufacturer's performance.

Description	Similar to Agilent Part #	qty.	cat.#
FID Flow Measuring Adaptor	19301-60660	ea.	21000

- FID Gauge Pack** for Agilent 5890 GCs
- Pressure regulators and gauges for air and hydrogen.
 - 1/8-inch bulkhead allows easy hookup to instrument.
 - Rated for inlet pressures to 250 psi (1,724 kPa).
 - Rated for outlet pressures of 0 to 60 psi (0–414 kPa).



Description	qty.	cat.#
FID Gauge Pack for Agilent 5890 GCs	ea.	22071

- FID Maintenance Kits** for Agilent GCs
- Include the most common consumable GC supplies and tools.
 - All parts meet or exceed performance of instrument manufacturer's parts.
 - Parts list makes reordering easy.

FID kits include:

- 1/4" and 0.4, 0.5, and 0.8 mm ID graphite ferrules
- FID/NPD capillary adaptor
- Capillary nuts
- Jet reamers/ferrule removers
- 1/4" nut
- Scoring wafer
- Capillary column caps
- Ignitor for either Agilent 5890 or 6890/6850/7890 GCs
- FID flow-measuring adaptor
- 1/4" x 5/16" wrench
- Installation gauge
- Wire cleaning brush
- High-performance Siltek® treated FID jet for either Agilent 5890 (adaptable jet) or 6890/6850/7890 (dedicated jet) GCs
- Spanner wrench
- FID jet removal tool



Description	qty.	cat.#
FID Maintenance Kit for Agilent 5890 GCs	kit	22180
FID Maintenance Kit for Agilent 6850/6890/7890 GCs	kit	22179

tech tip
Which FID Jet Should I Use?

There are two FID jet configurations for Agilent GCs. The longer "adaptable" jet fits both 5890 and 6890 GCs, and can be used with capillary or packed columns. The shorter "dedicated" jet is for the FID in the 6890/7890 GC that is designed only for use with capillary columns.

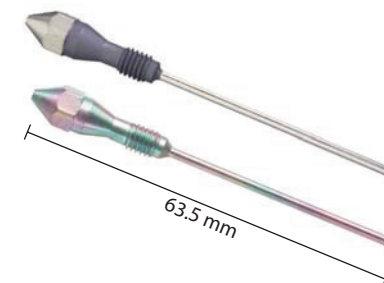
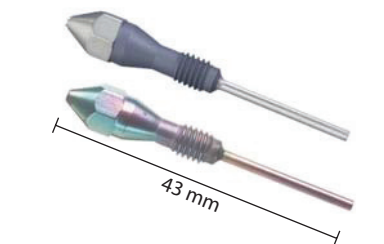
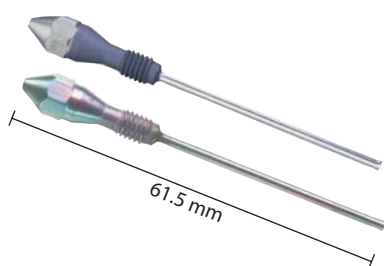

22328

FID Replacement Jets**Standard Version**

- Threads specially coated for easy installation and removal.
- Special processing ensures the highest degree of cleanliness.
- Meets or exceeds original manufacturer's performance.

High-Performance Version—Siltek® Treated

- Similar to the standard version, but Siltek® treated.
- Extremely inert, for use with active compounds.

Capillary Adaptable FID Replacement Jet for Agilent 5890/6890/6850 GCs

Engineered with a fluted tip to guide the capillary column into the jet.

Description	Similar to		qty.	cat.#	qty.	cat.#
	Agilent Part #					
Standard, 0.011-Inch ID Tip	19244-80560	ea.	20670		3-pk.	20671
High-Performance Siltek Treated, 0.011-Inch ID Tip	19244-80560	ea.	20672		3-pk.	20673

Capillary Dedicated FID Replacement Jet for Agilent 5890/6890/6850/7890 GCs

Description	Similar to		qty.	cat.#	qty.	cat.#
	Agilent Part #					
Standard, 0.011-Inch ID Tip	G1531-80560	ea.	21621		3-pk.	21682
High-Temperature, 0.018-Inch ID Tip	G1531-80620	ea.	23078		3-pk.	23079
High-Performance Siltek Treated, 0.011-Inch ID Tip	G1531-80560	ea.	21620		3-pk.	21683

Packed Column FID Replacement Jets for Agilent 5890/6890/6850 GCs

- 0.018-inch ID jets: Used for most general-purpose packed column applications.
- 0.030-inch ID jets: For packings that exhibit high bleed and that frequently clog the tip of smaller 0.018-inch jets.

Description	Similar to		qty.	cat.#	qty.	cat.#
	Agilent Part #					
Standard, 0.018-Inch ID Tip	18710-20119	ea.	21694		3-pk.	21695
High-Performance Siltek Treated, 0.018-Inch ID Tip	18710-20119	ea.	21696		3-pk.	21697

Description	Similar to		qty.	cat.#	qty.	cat.#
	Agilent Part #					
Standard, 0.030-Inch ID Tip	18789-80070	ea.	21688		3-pk.	21689
High-Performance Siltek Treated, 0.030-Inch ID Tip	18789-80070	ea.	21686		3-pk.	21687

FID Jet Removal Tool for Agilent 5890/6850/6890/7890 FIDs

- Securely grips jet in socket for easy removal or installation.
- Unique, ergonomic handle—easy to hold.



Slip tool over FID jet...

loosen jet...

and remove.

Description	qty.	cat.#
FID Jet Removal Tool for Agilent 5890/6890/6850/7890 FIDs	ea.	22328



23034

Torx® Screwdriver Set

- Set includes TR-10, TR-15, and TR-20.
- Ideal for performing routine maintenance on Agilent 6890 and 7890 GCs.

Description	qty.	cat.#
Torx Screwdriver Set	set	23034

Torx® is a registered trademark of Textron Inc.



20884

FID/NPD Adaptor Fitting

- Easy-to-use, sturdy, compact stainless steel fitting.
- 1/16-inch nut uses standard graphite or Vespel®/graphite ferrules.
- Wrench pad won't turn when installing a capillary column.
- Includes 1/4- and 1/16-inch stainless steel nuts, and 1/4-inch Vespel® and 0.4 mm ID graphite ferrules.

Description	qty.	cat.#
FID/NPD Adaptor Fitting	kit	20884



20120



FID/Injector Cleaning Kit

The FID/injector cleaning kit includes:

- Nylon tube brushes (1/8", 3/16", 1/4").
- Pipe cleaner.
- Stainless steel tube brushes (3/8", 3/16", 1/4").
- Stainless steel surface brush.
- Stainless steel jet reamers.
- Emery cloth.

Description	qty.	cat.#
FID/Injector Cleaning Kit	kit	20120

Injector/Detector Plug Nuts

- Use to cap off an injector to isolate leaks.
- Use to cap off a detector for thermal cleaning.
- Use to check a detector or make-up gas flow rate.
- Use to cap off a detector and prevent hydrogen from accidentally diffusing into the oven from an unused detector base.



21883

Description	Similar to Agilent Part#	qty.	cat.#
Injector/Detector Plug Nuts	5020-8294	2-pk.	21883



22077

FID/NPD Capillary Adaptor Fitting

for Agilent 5890/6890/6850 GCs

- High-quality stainless steel construction.
- Meets or exceeds original manufacturer's performance.

Description	Similar to Agilent Part #	qty.	cat.#
FID/NPD Capillary Adaptor Fitting	19244-80610	ea.	22077

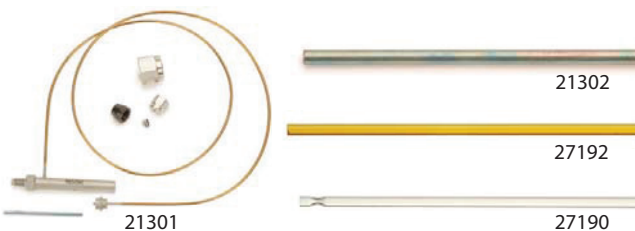

21301

21302

27192

27190

ECD/FID Dual-Purpose Make-Up Gas Kit

for Agilent 5890 GCs

Kit includes: replacement fitting, 1/4" nut, Vespel®/graphite ferrule, 1/16" nut, 0.4 mm ID graphite ferrule, Siltek®-treated guide.

Description	Similar to Agilent Part #	qty.	cat.#
ECD/FID Replacement Fitting Kit with Flow Manifold Connection		kit	21301
Replacement ECD Siltek Metal Guide		2-pk.	21302
Replacement ECD Fused Silica Liner	19233-20625	ea.	27192
		5-pk.	27193
Replacement Micro ECD Liner	G2397-20540	ea.	27190
		5-pk.	27191